

## Bulkhead Style Pressure & Vacuum Vents

Constructed of high strength and corrosion resistant Black Glass-Filled Polypropylene, the Bulkhead Vacuum Vents and Bulkhead Pressure Vents provide vacuum venting and pressure relief, respectively. These Vents come with EPDM or Viton seals and 316 Stainless Steel or Hastelloy-C springs, and are installed in exactly the same way a Bulkhead Fitting would be installed.

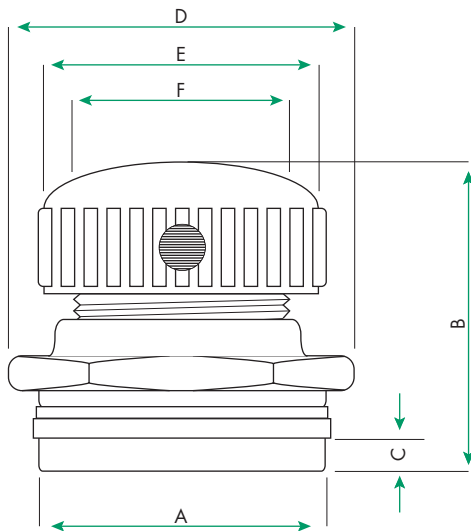

### SPECIFICATIONS

Pressure Relief Range: 10 to 14.7 PSI  
Initial Discharge: 12.5 PSI  
CFM: 2.4 ft<sup>3</sup>/m

Vacuum Vent Range: 1/4 to 1/2 PSI  
Initial Discharge: 1/4 PSI  
CFM: 1.09 ft<sup>3</sup>/m

DIM	A	B	C	D	E	F
INCHES	3.938	2.125	0.375	4.125	3	2.375*

\*Installation Hole Size is dimension "F"

PART #	ITEM DESCRIPTION
F7043020	2" PPG/Black Bulkhead Pressure Vent EPDM Seals & 316 SS Spring
F7043020V	2" PPG/Black Bulkhead Pressure Vent Viton Seals & 316 SS Spring
F7043020HS	2" PPG/Black Bulkhead Pressure Vent EPDM Seals & Hastelloy-C Spring
F7043020VHS	2" PPG/Black Bulkhead Pressure Vent Viton Seals & Hastelloy-C Spring
F7045020	2" PPG/Black Bulkhead Vacuum Vent EPDM Seals & 316 SS Spring
F7045020V	2" PPG/Black Bulkhead Vacuum Vent Viton Seals & 316 SS Spring
F7045020HS	2" PPG/Black Bulkhead Vacuum Vent EPDM Seals & Hastelloy-C Spring
F7045020VHS	2" PPG/Black Bulkhead Vacuum Vent Viton Seals & Hastelloy-C Spring